

# EPSON®



LIFETIME  
WARRANTY

## LW-PX750

Convenient • Practical • Advanced



4-24mm



LW-PX750



Made for industry, but easy enough to use in the home or office, the LW-PX750 is a portable label and bar code printer with exclusive time and cost-saving features for creating custom and compliant labels up to 1" (24mm) wide. Organize tool cribs, identify storage bins, make safety labels, tag assets, and more. With application-specific hotkeys, this easy-to-use label maker offers extraordinary flexibility to import images and print on the go.

The LW-PX750 features Mixed-Length printing for variable-length labels on a single, half-cut strip and Pick-and-Print for faster print-and-apply in the field. With Epson's innovative rollback technology, you save valuable tape with less lead margin waste.

POWERFUL DESIGN SOFTWARE



LW-PX750 works great as a stand-alone unit, or connected to a PC, using Epson's Label Editor Software. Create professional, custom labels that stand out either way!

AUTOMATED LABELING PROJECTS



Industry-specific hotkeys make complicated projects a breeze by automating tedious formatting.

IMPORT CUSTOM IMAGES



Import logos and images to the stand-alone machine from your PC, and take your branding everywhere you go!

TRIMMABLE CORNERS



Give your labels a longer life by rounding the corners. Prevent snags and peeling by using LW-PX750's built-in corner trimmer.

LIFETIME WARRANTY



Register your printer with us when you receive it, and you're covered for as long as you own it. **100% Covered. Always. You break it. We replace it. For life.**

And this warranty isn't some add-on service plan available at an additional cost. Instead, your warranty comes with your printer, so you'll never have to worry about life if it happens to your printer.

REDUCED TAPE WASTE

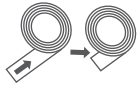

LW-PX750 can produce the tightest labels in the business, reducing tape waste with every label printed. The printer rewinds unused tape from the mouth of the printer prior to every print to minimize leading margins to as short as 4mm.

VERSATILE CUTTING

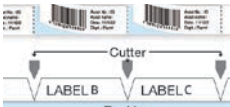

Epson LabelWorks' LW-PX750 has the power to half-cut, or "kiss cut" label tape, keeping your labels all together on one convenient strand.

SPECIAL CHARACTERS

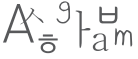

Use the accents and special characters key to make multi-lingual labels. LW-PX750 also comes pre-loaded with 14 fonts for a designer touch.

SCANNABLE LABEL



LW-PX750 can produce bar codes and QR Codes using the stand-alone unit, or connected to a PC.

AVAILABLE KITS



SKU: LW-PX750

- Kit Includes:**
- LW-PX750 Printer
  - ½" (12mm) Black on White Cartridge (212BWPX)
  - AC Adapter
  - FREE Label Editor Software Downloads (Unlimited Licenses)



SKU: LW-PX750PCD

- Kit Includes:**
- LW-PX750 Printer
  - ½" (12mm) Black on White VINYL Cartridge (212VBWPX)
  - AC Adapter
  - USB Cable
  - Semi-Soft Carrying Case
  - FREE Label Editor Software Downloads (Unlimited Licenses)

SPECIFICATIONS

PRINTER

- Technology:** Thermal Transfer  
**Tape Width:** 4-24mm / 1/6" -1"  
**Max Heat Shrink Tube Width:** 3-14mm / 1/8" -9/16"  
**Resolution:** 180dpi  
**Printer Head Width:** 18.1mm  
**Max Print Speed:** 30mm/sec (with AC Adapter)

HARDWARE

- Cutter:** Automatic with full-cut & half-cut options  
**Replaceable Cutter:** N/A  
**LCD:** 130x64 back-lit monochrome  
**Keyboard:** QWERTY  
**Internal Memory:** Up to 50 files and 5 images  
**Drop-Stop & Pick-n-print:** Yes  
**Detection:** Cover open, battery level, tape detection (type and size), tape end

CONNECTIVITY

- Interface:** USB  
**Compatible PC Software:** Epson Label Editor  
**Compatible Mac Software:** N/A  
**Compatible Apps (iOS 9.0 or later Android 5.0 or later):** N/A

POWER INFORMATION

- AC Adapter:** Yes  
**Battery:** 6 AA Batteries *(batteries not included)*

PRINTER SETTINGS & FEATURES

- Repeat Printing:** Yes  
**Auto Increment:** Yes  
**Number Serialization:** Up to 4 digits  
**Label Transfer from PC Software:** Yes  
**Store and Print Images:** Yes, up to 5\*  
**Mirror Printing:** Yes  
**Mix-Length:** Yes  
**Peel Guard Corner Rounder:** Yes  
**Minimum Margins:** 4mm lead, 1mm between labels  
**Vertical Printing:** Yes  
**Cable Wrap:** Yes  
**Flag:** Yes  
**Patch Panel:** N/A  
**Punch Block:** N/A  
**Faceplate:** N/A  
**Block 66:** N/A  
**Barcodes:** 8 formats  
**QR Code:** Yes  
**Symbols:** 892  
**Length:** Auto or custom  
**# of Fonts:** 14  
**Frames:** 72  
**Table:** 3

*\*From PC Software and Apps*

See next page for tape compatibility >  
Check LabelWorks.Epson.com for product updates, information, and current pricing





TAPE COMPATIBILITY: LW-PX750

| STANDARD INDUSTRIAL POLYESTER TAPE - 30ft (9m) |                                    |             |             |
|--|------------------------------------|-------------|-------------|
| IMPRINT  | TAPE                               | WIDTH       | PART NUMBER |
| Black  | Clear                              | 1/4" (6mm)  | 206BCPX†    |
|  |                                    | 3/8" (9mm)  | 209BCPX†    |
|  |                                    | 1/2" (12mm) | 212BCPX†    |
|  |                                    | 3/4" (18mm) | 218BCPX†    |
|  |                                    | 1" (24mm)   | 224BCPX†    |
|  | Translucent Matte (limited supply) | 3/4" (18mm) | 218BTMPX    |
|  | White                              | 1/6" (4mm)  | 204BWPX     |
|  |                                    | 1/4" (6mm)  | 206BWPX†    |
|  |                                    | 3/8" (9mm)  | 209BWPX**†  |
|  |                                    | 1/2" (12mm) | 212BWPX**†  |
|  |                                    | 3/4" (18mm) | 218BWPX**†  |
|  |                                    | 1" (24mm)   | 224BWPX**†  |
|  | Yellow                             | 1/4" (6mm)  | 206BYPX†    |
|  |                                    | 3/8" (9mm)  | 209BYPX**†  |
|  |                                    | 1/2" (12mm) | 212BYPX**†  |
|  |                                    | 3/4" (18mm) | 218BYPX**†  |
|  | Green                              | 1" (24mm)   | 224BYPX**†  |
|  |                                    | 1/4" (6mm)  | 206BGPX†    |
|  |                                    | 3/8" (9mm)  | 209BGPX†    |
|  |                                    | 1/2" (12mm) | 212BGPX†    |
|  |                                    | 3/4" (18mm) | 218BGPX†    |
|  | Blue                               | 1" (24mm)   | 224BGPX†    |
|  |                                    | 1/4" (6mm)  | 206BBPX†    |
|  |                                    | 3/8" (9mm)  | 209BBPX†    |
|  |                                    | 1/2" (12mm) | 212BBPX†    |
|  | Red                                | 3/4" (18mm) | 218BBPX†    |
|  |                                    | 1" (24mm)   | 224BBPX†    |
|  |                                    | 1/4" (6mm)  | 206BRPX†    |
|  |                                    | 3/8" (9mm)  | 209BRPX†    |
|  | Orange                             | 1/2" (12mm) | 212BOPX     |
|  |                                    | 3/4" (18mm) | 218BOPX     |
|  |                                    | 1" (24mm)   | 224BOPX     |
|  | White Removable                    | 1/2" (12mm) | 212RAPX†    |
|  | Purple                             | 3/4" (18mm) | 218BVPX     |
|  | Matte Silver                       | 3/8" (9mm)  | 209SMPX†    |
|  |                                    | 1/2" (12mm) | 212SMPX†    |
|  |                                    | 3/4" (18mm) | 218SMPX†    |
|  |                                    | 1" (24mm)   | 224SMPX†    |

| STANDARD INDUSTRIAL POLYESTER TAPE - 30ft (9m) |            |             |             |
|--|------------|-------------|-------------|
| IMPRINT  | TAPE       | WIDTH       | PART NUMBER |
| White  | Black      | 1/4" (6mm)  | 206WBPX†    |
|  |            | 3/8" (9mm)  | 209WBPX†    |
|  |            | 1/2" (12mm) | 212WBPX†    |
|  |            | 3/4" (18mm) | 218WBPX†    |
|  |            | 1" (24mm)   | 224WBPX†    |
|  |            | 1/2" (12mm) | 212WRPX     |
|  | Vivid Red  | 3/4" (18mm) | 218WRPX     |
|  |            | 1" (24mm)   | 224WRPX     |
|  | Vivd Green | 1/2" (12mm) | 212WGPX     |
|  |            | 3/4" (18mm) | 218WGPX     |
|  |            | 1" (24mm)   | 224WGPX     |
|  | Vivid Blue | 1/2" (12mm) | 212WLPX     |
|  |            | 3/4" (18mm) | 218WLPX     |
|  |            | 1" (24mm)   | 224WLPX     |
|  | Clear      | 1/2" (12mm) | 212WCPX†    |
|  |            | 3/4" (18mm) | 218WCPX†    |
|  |            | 1" (24mm)   | 224WCPX†    |
| Red  | White      | 1/2" (12mm) | 212RWPX†    |



| FLUORESCENT POLYESTER TAPE - 30ft (9m)       |                    |  |             |
|--|--------------------|--|-------------|
| IMPRINT                                      | TAPE               | WIDTH                                  | PART NUMBER |
| Black  | Fluorescent Red    | 3/4" (18mm)                            | 218FRPX     |
|  | Fluorescent Pink   |  | 218FPPX     |
|  | Fluorescent Orange |  | 218FOPX†    |
|  | Fluorescent Yellow |  | 218FYPX†    |
|  | Fluorescent Green  |  | 218FGPX†    |
| STRONG ADHESIVE POLYESTER TAPE- 30ft (9m)    |                    |  |             |
| Black  | White              | 3/8" (9mm)                             | 209IBWPX†   |
|  |                    | 1/2" (12mm)                            | 212IBWPX†   |
|  |                    | 3/4" (18mm)                            | 218IBWPX†   |
|  |                    | 1" (24mm)                              | 224IBWPX†   |
|  | Yellow             | 3/8" (9mm)                             | 209IBYPX†   |
|  |                    | 1/2" (12mm)                            | 212IBYPX†   |
|  |                    | 3/4" (18mm)                            | 218IBYPX†   |
|  |                    | 1" (24mm)                              | 224IBYPX†   |
| Gold   | Clear              | 1/2" (12mm)                            | 212GCPX†    |
|  | Black              | 1/2" (12mm)                            | 212GBPX     |
| VINYL TAPE - 22.9ft (7m)                     |                    |  |             |
| Black  | White              | 1/2" (12mm)                            | 212VTBWPX** |
|  |                    | 3/4" (18mm)                            | 218VTBWPX** |
|  |                    | 1" (24mm)                              | 224VTBWPX** |
|  | Yellow             | 1/2" (12mm)                            | 212VTBYPX** |
|  |                    | 3/4" (18mm)                            | 218VTBYPX** |
|  |                    | 1" (24mm)                              | 224VTBYPX** |
| VINYL SELF-LAMINATING OVERWRAP - 26.2ft (8m) |                    |  |             |
| Black  | White              | 1" (24mm), 1/4" White, 3/4" Clear Tail | 224VSLPX**† |

Wire wrap tape prints on white area and has a clear tail to overlap printed material.

| EXTRA TOUGH NYLON TAPE - 19ft (5.8m) |       |             |             |
|--------------------------------------|-------|-------------|-------------|
| Black                                | White | 1/2" (12mm) | 212NYLBWPX† |
|                                      |       | 3/4" (18mm) | 218NYLBWPX† |
|                                      |       | 1" (24mm)   | 224NYLBWPX† |

It is recommended to cut nylon tape using scissors to prolong the life of your printer's built-in cutter.

| MAGNETIC TAPE - 4.9ft (1.5m) |        |             |               |
|------------------------------|--------|-------------|---------------|
| IMPRINT                      | TAPE   | WIDTH       | PART NUMBER   |
| Black                        | White  | 1/2" (12mm) | 212MTBWPX-4.9 |
|                              |        | 3/4" (18mm) | 218MTBWPX-4.9 |
|                              |        | 1" (24mm)   | 224MTBWPX-4.9 |
|                              | Yellow | 1/2" (12mm) | 212MTBYPX-4.9 |
|                              |        | 3/4" (18mm) | 218MTBYPX-4.9 |
|                              | Red    | 1" (24mm)   | 224MTBYPX-4.9 |
|                              |        | 1/2" (12mm) | 212MTBRPX-4.9 |
|                              |        | 3/4" (18mm) | 218MTBRPX-4.9 |
|                              | Blue   | 1" (24mm)   | 224MTBRPX-4.9 |
|                              |        | 1/2" (12mm) | 212MTBBPX-4.9 |
|                              | Green  | 3/4" (18mm) | 218MTBBPX-4.9 |
|                              |        | 1" (24mm)   | 224MTBBPX-4.9 |

It is recommended to cut magnetic tape using scissors to prolong the life of your printer's built-in cutter.

| HEAT SHRINK TUBE - 98in (2.4m) |        |                   |       |              |              |
|--------------------------------|--------|-------------------|-------|--------------|--------------|
| IMPRINT                        | TAPE   | NOMINAL DIAMETER  | AWG   | SHRINK RATIO | PART NUMBER  |
| Black                          | Red    | 3/16" (4mm)       | 8-12  | 2:1          | 205STBRPX    |
|                                |        | 1/2" (12mm)       | 2-8   | 2:1          | 211STBRPX    |
|                                | Yellow | 1/8" (3mm)        | 16-22 | 3:1          | 203YLBYPX    |
|                                |        | 3/16" (4mm)       | 8-12  | 2:1          | 205STBYPX    |
|                                |        | 1/4" (6mm)        | 6-18  | 3:1          | 208B20BYPX** |
|                                |        | 1/2" (12mm)       | 2-8   | 2:1          | 211STBYPX    |
|                                | White  | 1/8" (3mm)        | 16-22 | 3:1          | 203YLBWPX    |
|                                |        | 3/16" (4mm)       | 8-12  | 2:1          | 205STBWPX    |
|                                |        | 1/4" (6mm)        | 6-18  | 3:1          | 208B20BWPX** |
|                                |        | 3/8" (9mm) 90in/L | 4-12  | 3:1          | 210STBWPX-90 |
|                                |        | 1/2" (12mm)       | 2-8   | 2:1          | 211STBWPX    |
|                                |        | 9/16" (14mm)      | 0-5   | 2:1          | 214STBWPX    |
|                                | Blue   | 3/16" (4mm)       | 10-18 | 3:1          | 205YLBBPX    |
| White                          | Black  | 3/16" (4mm)       | 8-12  | 2:1          | 205STWBPX    |
|                                |        | 1/2" (12mm)       | 2-8   | 2:1          | 211STWBPX    |

Compliance Standards: UL Standard 224 (Related Temperature: 125° C, Rated Voltage: 300V, Flame Resistance Grade VW-1). It is recommended to cut heat shrink tube using scissors to prolong the life of your printer's built-in cutter.

| DESIGNER COLLECTION   |  |
|---|--|
| Visit <a href="https://labelworks.epson.com/for-home/supplies.html">labelworks.epson.com/for-home/supplies.html</a> to view our designer collection |  |

\* INDICATES THAT SUPPLY IS ALSO AVAILABLE IN STANDARD CARTRIDGES  
\*\* INDICATES THAT SUPPLY IS ALSO AVAILABLE IN BULK ROLL (BULK ONLY COMPATIBLE WITH Z PRINTERS)  
† INDICATES THAT SUPPLY HAS SPLIT-BACK LINING



## GET IN TOUCH



**Phone**  
+1 800.458.3430  
M-F 8am-4pm CST



**Fax**  
+1 888.865.2235



**Email**  
shop@labelworks.epson.com



**Web**  
labelworks.epson.com



**Address**  
PO Box 309, 370 SMC Drive  
Somerset, WI 54025

## FOLLOW US



# EPSON®